

**Narrow
Lot
Plan**



**The Brookside
Stock Plan #1892**

Special Features:

- 1892 S.F. Total Living Area
892 sf Main
1000 sf Upper
- 3 bedrooms, 2.5 baths
- Great Room concept
- Optional 4 Bedroom layout
- Optional sliding door in dining room without bay window
- 2 car Garage
- Overall Exterior dimensions:
30'-0" width x 53'-8" depth

Narrow Lot Plan

In our effort to constantly update and improve our designs, we reserve the right to modify or change our plans



main : 868 sf

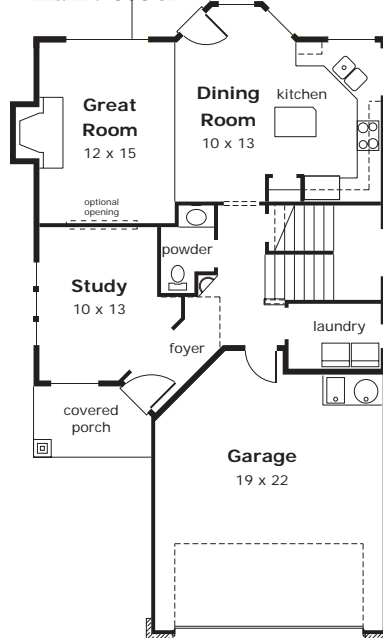

upper: 1000 sf

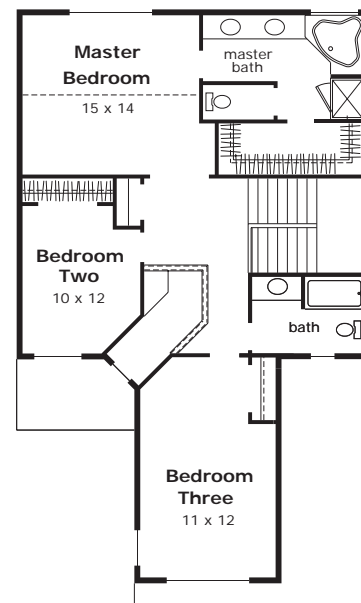

optional upper:
1160 sf
shown at
reduced scale

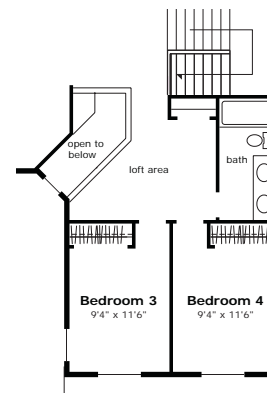

The Residential Plan Center

11644 N.E. 80th St. • Kirkland, WA 98033 • (425) 828-4117

www.NashJonesAnderson.com